

George Ward School, Melksham

- KEY**
- 1.8m High Screen Wall
 - 1.8m High Closeboard Fence
 - 1.8m High Panel Fence
 - 1.2m High Post & Wire Fence
 - 1.8m High Hit & Miss Fence
 - Indicative Landscape Areas
 - Indicative Tree Positions
 - Affordable Housing
 - Timber Gate 1.8m High
 - Visitor Parking
 - Front Access Path 0.9m wide
 - Rear Access Path 0.6m wide
 - Patio area (HA only) 1.8m x 1.8m
 - Rumble Strip
 - Block Paving
 - Bin Collection Areas
- Note: All existing boundaries to be reinforced where required.

No. Dwellings	Type	Area	Bedrooms	Total Area	Garage	Stories
PERSIMMON 2013 HOUSE TYPES						
4	Flat	598	2 bed flat	2392	parking	3
8	Flat	628	2 bed flat	3026	parking	3
11	Arwick	631	2 bed semi/ter	6941	parking	2
18	Harbury	761	2 bed + semi/ter	13698	parking	2
22	Rufford	870	2 bed + semi/det	19140	int	2
26	Souler	932	3 bed semi/ter	24232	parking	2.5
11	Wadfield	969	3 bed semi/det	10659	parking/det	2
9	Clayton	999	3 bed semi/det	8991	parking/det	2
22	Rosberry	1096	3 bed + det	24112	int	2
17	Warwick	1333	4 bed + det	22661	int	2
13	Corfe	1414	4 bed det	18382	det	2
22	Madegh	1574	4 bed det	34628	det	2
183				190860		
WESTBURY AFFORDABLE HOUSE TYPES						
12	WPF 1210A	514	1 bed Flat	6168	parking	3
12	WPF 1210B	631	2 bed Flat	7572	parking	3
37	WP2420A	803	2 bed semi/ter	29711	parking	2
17	WP 3520A	908	3 bed semi/ter	15436	parking	2
78				58887		
Total Sq Ft				249747		
Total M Sq				23202		
Total Dwellings				261		
NET Total approx site area (within red line)				6.20 ha		
				15.32 acres		
Approx dev't density (within red line)				16301 sq' to the acre		
				17 plots / acre		

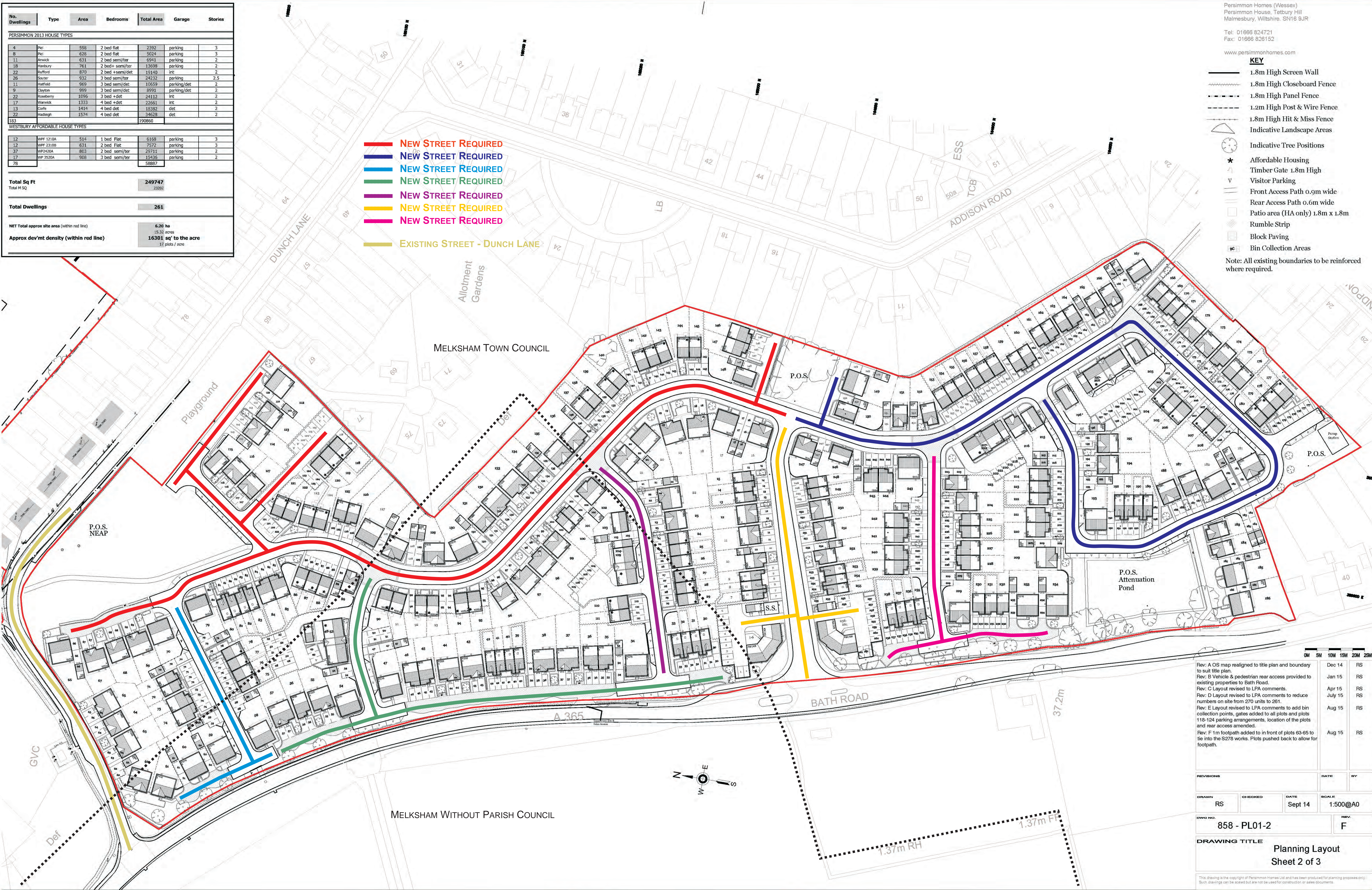

- NEW STREET REQUIRED
- NEW STREET REQUIRED
- NEW STREET REQUIRED
- NEW STREET REQUIRED
- NEW STREET REQUIRED
- NEW STREET REQUIRED
- EXISTING STREET - DUNCH LANE

REV	DESCRIPTION	DATE	BY
Rev: A	OS map realigned to title plan and boundary to suit title plan.	Dec 14	RS
Rev: B	Vehicle & pedestrian rear access provided to existing properties to Bath Road.	Jan 15	RS
Rev: C	Layout revised to LPA comments.	Apr 15	RS
Rev: D	Layout revised to LPA comments to reduce numbers on site from 270 units to 261.	July 15	RS
Rev: E	Layout revised to LPA comments to add bin collection points, gates added to all plots and plots 118-124 parking arrangements, location of the plots and rear access amended.	Aug 15	RS
Rev: F	1m footpath added to in front of plots 63-65 to tie into the S278 works. Plots pushed back to allow for footpath.	Aug 15	RS

REVISIONS	DATE	BY		
DRAWN	RS	CHECKED	DATE	SCALE
			Sept 14	1:500@A0
DWG NO.		F		
858 - PL01-2				
DRAWING TITLE				
Planning Layout Sheet 2 of 3				

This drawing is the copyright of Persimmon Homes Ltd and has been produced for planning purposes only. Such drawings can be scaled but are not to be used for construction or sales documents.